

PortAventura  
Convention Centre  
a escasos 100 m.  
del Hotel PortAventura

PortAventura  
Convention Centre  
100 m. of the  
Hotel PortAventura



**CONVENTION CENTRE**  
**LEVEL 0**  
13.000 m<sup>2</sup>  
EN DOS PLANTAS

	SURFACE m <sup>2</sup> /sqm	Height m	Theatre	School	"U"	Banquet	Cocktail	Cabaret
Alexandría 1	1.016	6,85	1200	740	-	690	820	400
Alexandría 2	1.038	6,85	1200	740	-	710	840	410
Alexandría 3	198	4,88	210	110	30	150	180	60
Alexandría 4	201	4,88	210	110	30	150	180	60
Alexandría 5	174	4,88	180	90	30	130	150	40
Additional meeting area**	132	-	-	-	-	-	-	-
<b>TOTAL (con pasillo de servicio/with service hallway)</b>	<b>2.759</b>		<b>3.100</b>	<b>1.850</b>	<b>-</b>	<b>1.960</b>	<b>2.320</b>	<b>1.100</b>
Alexandría 1 (graderio/tiered seating)	436		625					
Alexandría 2 (graderio/tiered seating)	436		625					
<b>TOTAL</b>	<b>872</b>		<b>1.250</b>					
Barcino 1	98	3,47	98	45	24	70	90	30
Barcino 2	116	3,47	98	45	24	80	100	36
Barcino 3	97	3,47	98	45	24	70	80	30
<b>TOTAL</b>	<b>312</b>		<b>378</b>	<b>171</b>	<b>-</b>	<b>230</b>	<b>270</b>	<b>132</b>

Office 1 18 3,30

www.portaventuraevents.com +34 977 779 206 be@portaventura.es

\*Este espacio no se comercializa individualmente.  
\*This space is not marketed individually.

# CONVENTION CENTRE LEVEL 1 13.000 m<sup>2</sup> ON TWO FLOORS

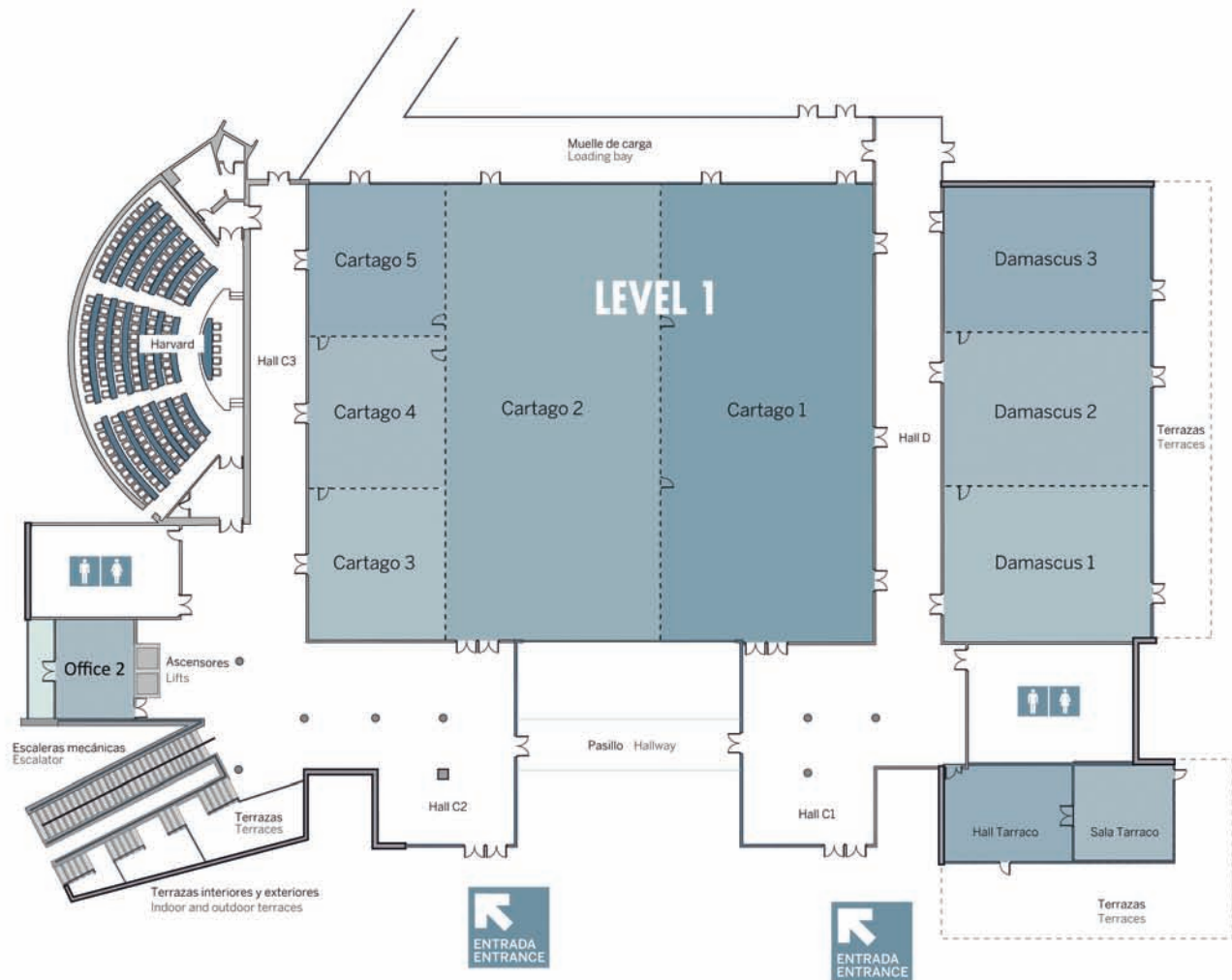

	SURFACE m <sup>2</sup> /sqm	Height m.	Theatre	School	"U"	Banquet	Cocktail	Cabaret
Cartago 1	685	4,27	720	440	42	500	590	300
Cartago 2	694	4,27	720	440	42	520	610	312
Cartago 3	148	4,27	162	72	24	110	130	54
Cartago 4	152	4,27	162	72	24	110	130	54
Cartago 5	148	4,27	162	72	24	110	130	54
<b>TOTAL</b>	<b>1.870</b>		<b>1.950</b>	<b>1.200</b>	-	<b>1.360</b>	<b>1.600</b>	<b>800</b>
Damascus 1	221	4,27	170	110	30	150	200	90
Damascus 2	226	4,27	180	110	30	150	200	90
Damascus 3	228	4,27	180	110	30	150	200	90
<b>TOTAL</b>	<b>675</b>		<b>740</b>	<b>450</b>	-	<b>500</b>	<b>600</b>	<b>280</b>
Harvard	259	3,60	150 (anfiteatro / amphitheatre)					
Tarraco	70		14 (imperial / board)					
Office 2	48	3,80						