

The Summit Pavilion

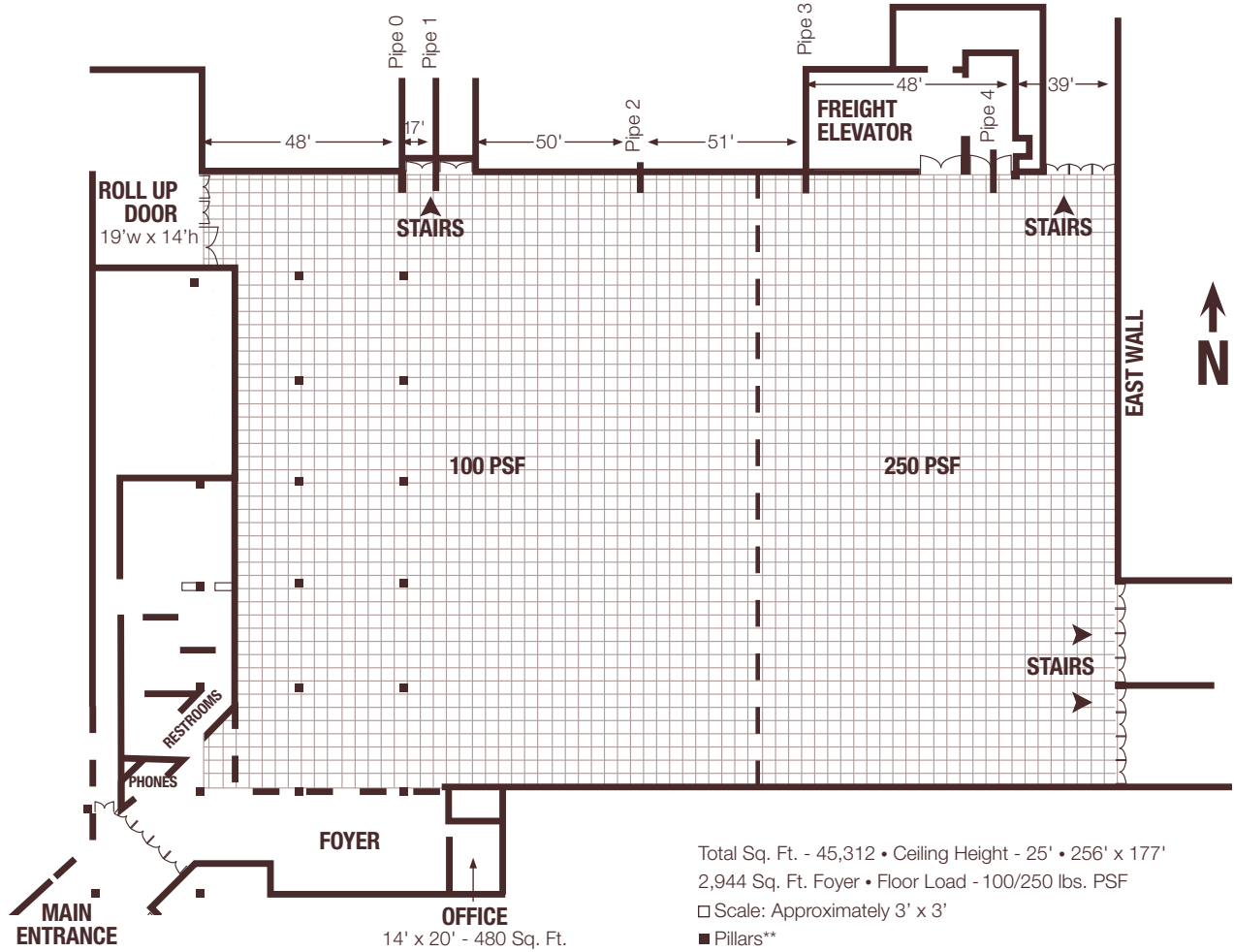

Room Capacities*

	THEATRE	CLASSROOM	BANQUET	RECEPTION	10' x 10' EXHIBIT
THE SUMMIT PAVILION	4,000	1,700	2,140	4,000	265
SUMMIT E (EWALL-PIPE 3)	1,200	900	1,070	1,200	90
SUMMIT CTR (PIPE 2-PIPE 4)	1,600	1,080	1,120	1,600	98
SUMMIT W (PIPE 1-PIPE 3)	1,900	1,260	1,400	1,900	140

* Capacity figures are subject to change, depending on space allocations for head table, dance floor, staging and catering requirements.

** Pillars may obstruct view in some configurations.

SOUND: Altec coaxial ceiling speakers.

LIGHTING: Dimmable ceiling track system.

POWER: Five 400 amp 208 volt 3 phase disconnect boxes. Complete ceiling track system with 20 amp 208 volt 3 phase service. Fifty-five 30 amp 208 volt 3 phase floor pockets with 20 amp 110 volt dedicated circuit.

Accommodates 265 - 10' x 10' Booths • 310 - 8' x 10' Booths

